

Comus Group of Companies

PRODUCT DATA SHEET

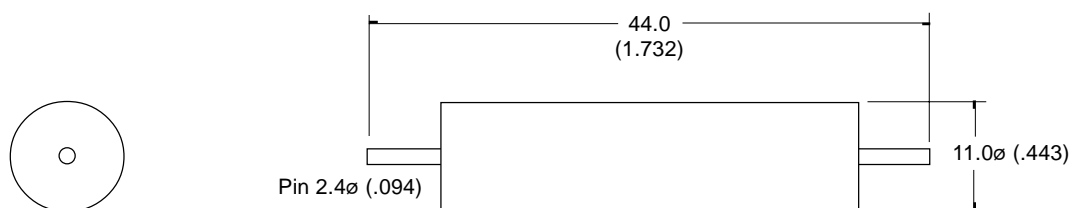

Drawings not to scale
All dimensions in mm (inches) nominal

These switches operate when tilted from the horizontal position. The switch movement required to cause contact change (example off to on) is called the differential angle. It is very important when designing a tilt switch to allow for the differential angle and understand that when in the horizontal position the switch contact may be open or closed.

SWITCHING VOLTAGE
Unless specified switches can be used on AC and DC loads. For DC voltages reduce AC rating to 70%.

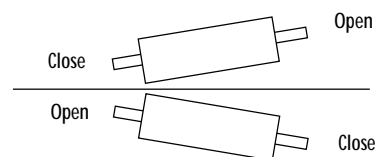

Changeover contacts break before make

SPECIFICATION

CONTACT FORM/STYLE		Change-over
SWITCHING VOLTAGE	Max. Vac	240
SWITCHING CURRENT	Max. A	5.0 at 240 Vac
SWITCHING CAPACITY (RESISTIVE)	Max. VA	1200
DIFFERENTIAL ANGLE	Max. Deg°	10
CONTACT RESISTANCE	Max. Ω	3
OPERATING TEMPERATURE	Deg. °C	-37° + 100°
STORAGE TEMPERATURE	Deg. °C	-40° + 125°
CASE MATERIAL		Steel-tin plated
MOUNTING CLIPS		5DL
FEATURES		2 Electrodes - High Power

NOTE: When cutting or bending switch leads it is important that the glass seal is not damaged. The cutting or bending point should be no closer than 3mm (.118) to the glass to metal seal and the lead should be supported between the cutting or bending point and the glass to metal seal.

TILT SWITCH - Metal - Mercury Contacts

PART NUMBER
CM 1050-0

Rev. No.	Revision Note	Date	Signature
D	Web Site 2001	1-2-01	RG

The Comus Group of Companies consist of:
Assemtech Europe Limited
E. Bachem GmbH
Comus International
W. Gunther GmbH
Gunther Belgium
Gunther France
S.T.G.

As part of the company policy of continued product improvement, specifications may change without notice. Our sales office will be pleased to help you with the latest information on this product range and details of our full design and manufacturing service. All products are supplied to our standard conditions of sale otherwise agreed in writing.