

DRAWING #: CMI600-0

REV.	DATE	REVISION DESCRIPTION	DR.
A	9/01/95	ORIGINAL	L.R.
B	6/98	UPDATE TO TO ISO 9000	S.T.
C	5/07/03	ADD MEASURING ANGLE 45° FOR C.R.	L.L.
D	12/4/03	ECN 2003-014	WT

- NOTES:
1. ELECTRICAL:
 - 1.1 CONTACT CAPACITY: 0.15 A, 24 V DC.
 - 1.2 CONTACT RESISTANCE 5 OHMS MAX., MEASURED AT 45° BELOW HORIZONTAL.
 2. OPERATE:
 - 2.1 DIFFERENTIAL ANGLE 2° MAX.
 - 2.2 MAXIMUM MAKE ANGLE 10° BELOW HORIZONTAL.
 - 2.3 MAXIMUM BREAK ANGLE 10° ABOVE HORIZONTAL.
 - 2.4 OPERATING TEMPERATURE -37° C TO 100° C.
 3. FINISH:
 - 3.1 EXTERNALLY TIN PLATED.

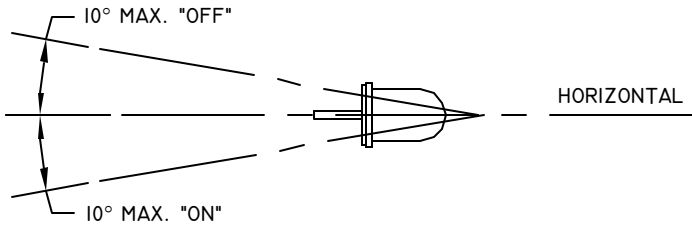
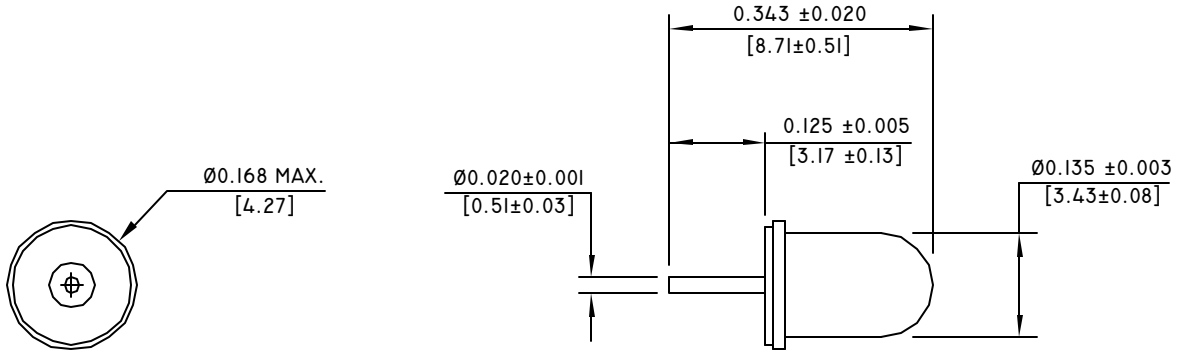

WORKING POSITION

COMUS INTERNATIONAL
 454 ALLWOOD ROAD, CLIFTON, NEW JERSEY 07012 TEL. (973) 777-6900

ENGINEERING		
QUALITY		
PRODUCTION		
APPROVAL	SIGNATURE	DATE

UNSPECIFIED TOLERANCES
 DECIMAL: .XX ±.01 [.254]
 .XXX ±.005 [.127]
 FRACTIONAL: ± 1/64 [.397]
 ANGULAR: ± 1/2°

REF.:	SCALE: NONE	DRAWN BY: L.L.	DATE 5/07/2003
TITLE: TILT SWITCH		DRAWING #: CMI600-0	