

Part Number: PRA-SP-021 (Alternate Part No: S1899)
Seating Occupancy Reed Switch
Product Data Sheet

PICTURE

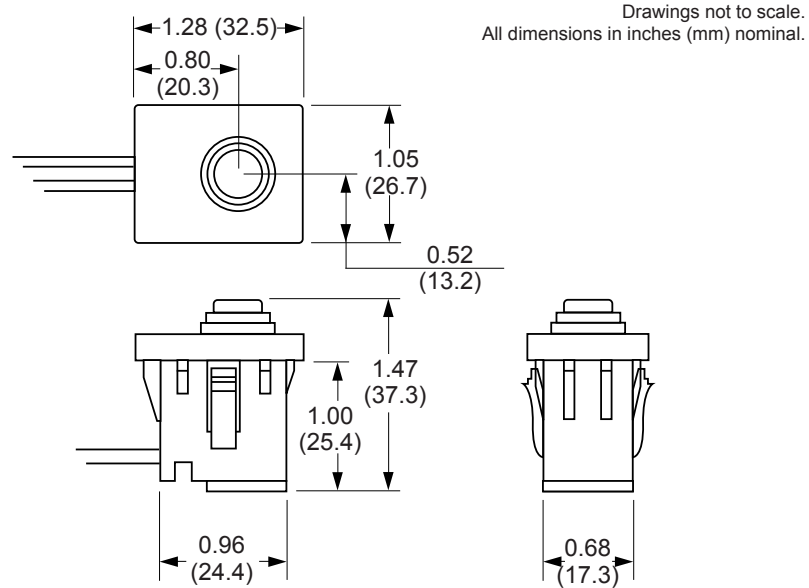

DIMENSIONS



✓RoHS Compliant

SPECIFICATION

Contact Form		Normally Open
Contact Material		Rhodium
Switching Capacity	Max.	10 VA
Switching Voltage	Max.	150 VAC/DC
Switching Current	Max.	0.5 A
Carrying Current	Max.	1.0 A
Dielectric Strength	Min.	150 VDC
Contact Resistance	Max.	100 mOhms
Insulation Resistance	Min.	10 ⁹
Pull-In Sensitivity		10 - 35 AT
Drop-Out Sensitivity	Min.	5
Bounce Time	Max.	0.2 ms
Release Time	Max.	0.05 ms
Resonant Frequency	Typ.	5000 Hz
Operating Frequency	Max.	200 Hz
Vibration (10-1000 Hz)		35 g
Shock (11 ms)		50
Capacitance	Typ.	0.7 pF
Operating Temperature Range		-40°C to +125°C
Test Coil	Type	1035

As part of the company policy of continued product improvement, specifications may change without notice. Our sales office will be pleased to help you with the latest information on this product range and the details of our full design and manufacturing service. All products are supplied to our standard conditions of sale unless otherwise agreed in writing.

Phone: (1) 973 777 6900 **www.comus-intl.com** **Fax: (1) 973 777 8405**